

## EN PKAS3FI / PKAS3FIR product information sheet

### High-gloss glass ceramic:



### PKAS3FI

Pro surface induction set

(1 × PKAS3, 2 × PKFI3, 1 × EFBV90, 1 × EFS375, 1 × EFV)

### Matt glass ceramic:



### PKAS3FIR

Pro surface induction Rough set

(1x PKAS3, 2x PKFI3R, 1x EFBV90, 1x EFS375, 1x EFV)

### General product information:

Product:	set consisting of two Pro surface induction cooktops, one Pro cooktop extractor system with integrated fan and corresponding BORA Ecotube products. Other components are available separately (e.g. odour filters, wall sleeves, etc.) for exhaust air and recirculation models.
Product highlights:	cooktops with extra-large surface induction cooking zones, intuitive control knob with analogue/digital operation (knob ring and touch surface), cooktop extractor with automatic cover flap to open and close the air inlet opening
Minimum installation dimensions: (1 extractor, 2 cooktops)	Kitchen unit with a min. width of 90 cm
Safety and warning information:	See operating and installation instructions
Energy efficiency class:	 (applies to the exhaust air model)

### Components:

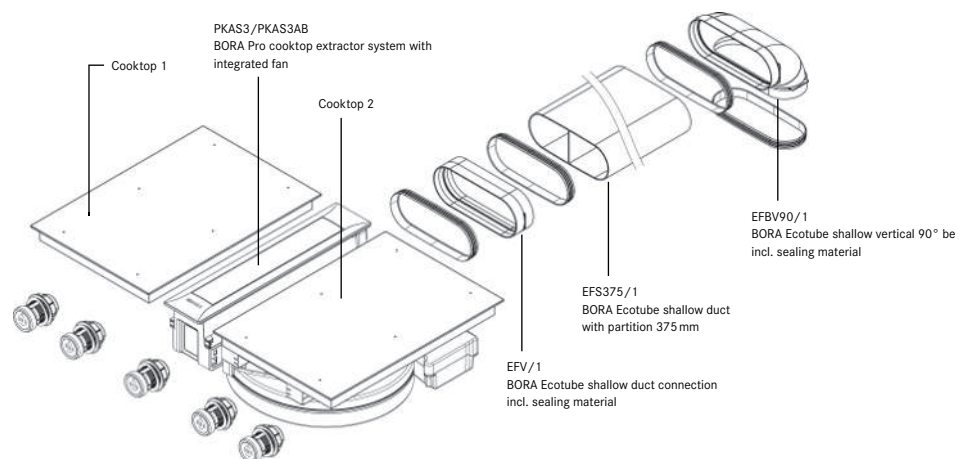

# PKAS3/PKAS3AB

Pro cooktop extractor system with integrated fan (...All Black)

## Technical data

Supply voltage	220-240 V
Frequency	50/60 Hz
Maximum power consumption	550 W
Dimensions (width × depth × height)	468 × 540 × 199 mm
Weight (incl. accessories / packaging)	12.5 kg
Surface material	Stainless steel 1.4016
Cooktop extractor power levels	1-9, P
Duct connection	BORA Ecotube
Control unit power supply cable	2 m
Control knob connection cable	0.25 m

## Product description

- Modular system
- Integrated fan
- Intuitive control knob
- Automatic cover flap
- Integrated grease drip tray
- Stainless steel grease filter
- Central components for the entire system

## Functions

- Automatic extractor function
- Automatic after-run
- Power setting
- Filter service life and filter service display (recirculation only)
- Cleaning function
- Short-time timer
- Super simple mode

## Safety features

Child lock, safety shut-down, anti-trap protection

## Scope of delivery

Pro cooktop extractor system with integrated fan PKAS3/PKAS3AB, control knob, cover flap, stainless steel grease filter, filter tray, maintenance tray, control knob connection cable, mains supply cable with type E + F plugs, operating and installation instructions, installation accessories

## Accessories

Stainless steel grease filter PKA1FF, cover flap PKA1VK/PKA1VKAB, filter tray PKA1FW, mains supply cable type I UNLI (AUS) / type J UNLJ (CH) / type G UNLG (GB-IE) / type B UNLB (PH) / type H UNLH (IL)

## Product and planning information

- Suitable for use as a recirculation or exhaust system
- Duct connection always on the back of the appliance on the right-hand side
- Suitable for use with all BORA Professional 3.0 cooktops
- Up to 2 cooktops can be connected to each cooktop extractor
- Long or complex exhaust channels possible using an additional fan module
- Customisable worktop height
- Worktop depth  $\geq 700$  mm
- Flush installation or surface mounting possible
- The drawers or shelves in the base unit must be removable (for maintenance and cleaning)
- Suitable for use with all BORA sockets
- When installation is complete, the appliance is to be sealed in using heat-resistant silicone sealant

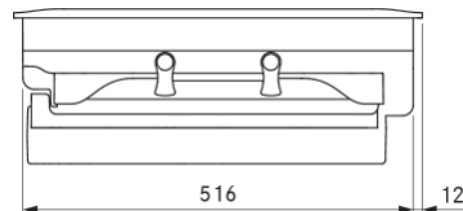
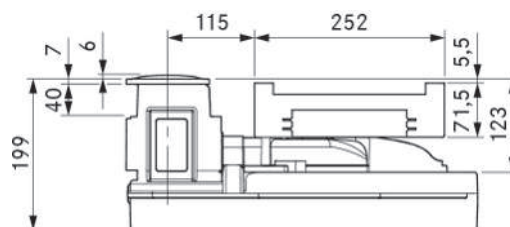
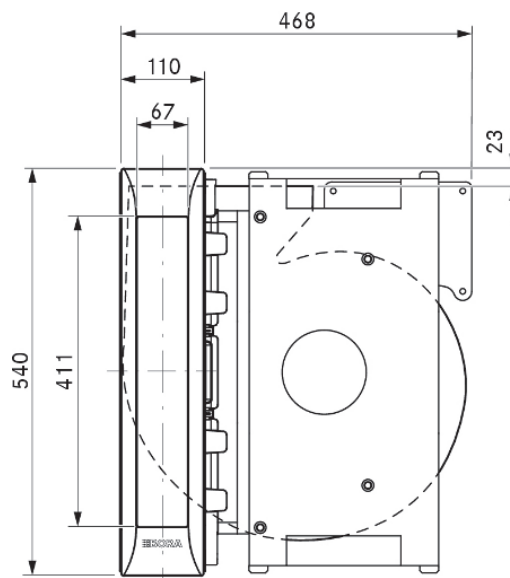
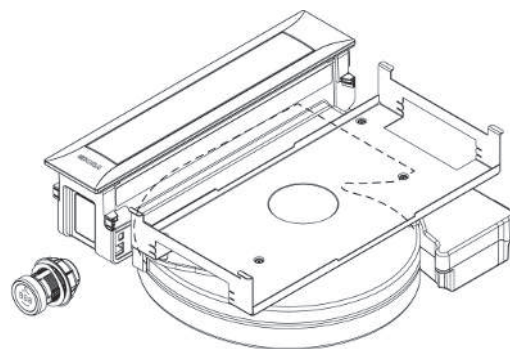

# PKFI3 / PKFI3AB

Pro surface induction cooktop (...All Black)

## Technical data

Supply voltage	220-240 V
Frequency	50-60 Hz
Maximum power consumption	3680 W
Maximum power rating	3680 W
Fuse protection	1 × 16 A
Dimensions (width × depth × height)	370 × 540 × 52 mm
Weight (incl. accessories / packaging)	8.1 kg
Surface material	Glass ceramic
Cooktop power levels	1-9, P
Size of front cooking zone	230 × 230 mm
Size of rear cooking zone	230 × 230 mm
Front cooking zone output	2100 W
Rear cooking zone output	2100 W
Front cooking zone output on power setting	3680 W
Rear cooking zone output on power setting	3680 W
Cooktop power supply cable	1.5 m
Cooktop-to-extractor communication cable	1 m
Control knob connection cable	1 m

## Product description

- Intuitive control knob
- Oversized surface induction cooking zones
- Cooktop power display
- Demo mode
- Also with matt glass ceramic (in sets combining PKAS3FIR, PKAS3FIABR and PKAS3FITR)

## Functions

- Power setting
- Pan size recognition
- Cooking zone timer
- Automatic heat-up function
- Variable heat retention function
- Bridging function
- Pause function
- Super simple mode

## Safety features

Child lock, residual heat indicator, overheating protection, safety shut-down

## Scope of delivery

Surface induction cooktop PKFI3/PKFI3AB, 2 control knobs, 2 control knob connection cables, connection cable to the extractor, operating and installation instructions, installation accessories

## Accessories

Grill pan for surface induction KWGPFI

## Product and planning information

- Rotation by 180° only possible if installed with cooktop extractor
- Sufficient ventilation below the cooktop must be ensured
- Induction cookware required
- Can be operated with limited functions without a cooktop extractor
- When installation is complete, the appliance is to be sealed in using heat-resistant silicone sealant

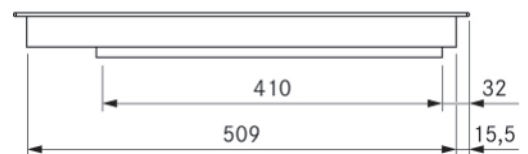
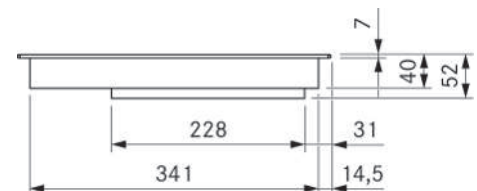
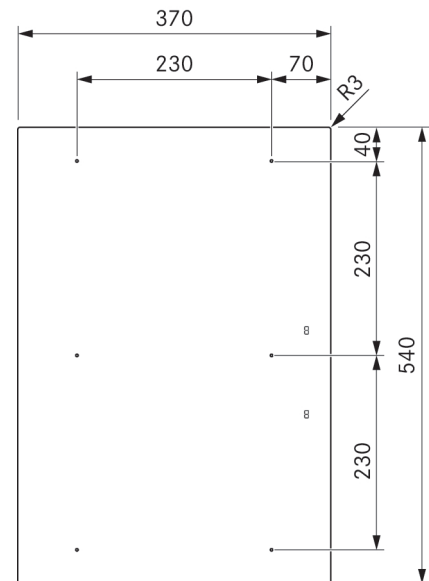
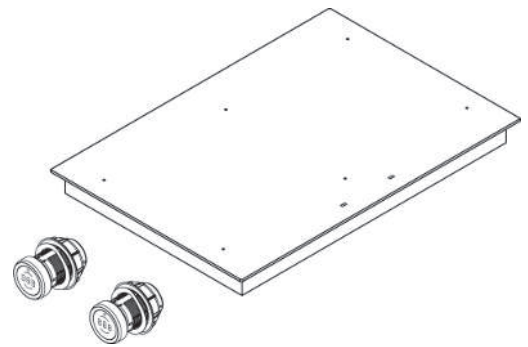

## EFBV90/1

Ecotube 90° bend, flat vertical incl. sealing material

### Technical data

Dimensions (width × depth × height)	255 × 139 × 139 mm
Weight (net)	0.35 kg
Material properties	Class C according to DIN EN 13501-1

### Scope of delivery

2 flat seals EFD

### Accessories

- Mounting bracket set EFMS

### Product and planning information

- Moulded part with a shallow socket design

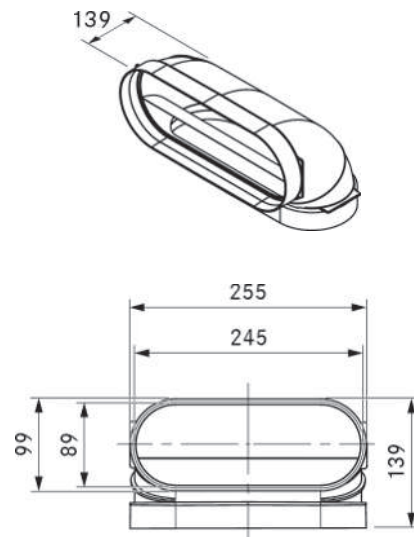

## EFS375/1

Ecotube shallow duct with partition 375 mm

### Technical data

Dimensions (width × depth × height)	245 × 375 × 89 mm
Weight (net)	0.85 kg
Material properties	Class C according to DIN EN 13501-1

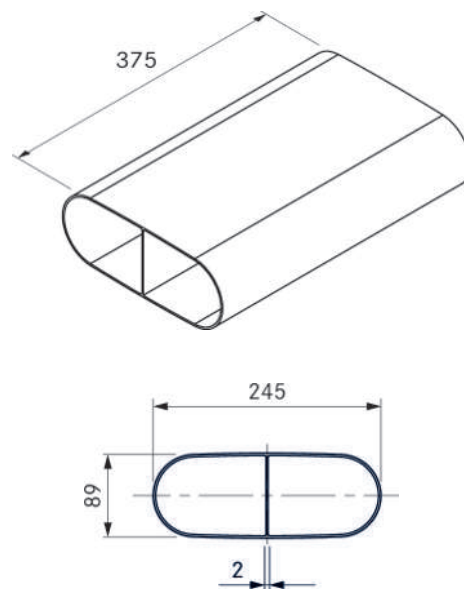

## EFV/1

Ecotube duct connection, flat incl. sealing material

### Technical data

Dimensions (width × depth × height)	255 × 50 × 99 mm
Weight (net)	0.12 kg
Material properties	Class C according to DIN EN 13501-1

### Scope of delivery

2 flat seals EFD

### Accessories

Mounting bracket set EFMS

### Product and planning information

- Moulded part with two shallow sockets

